

Indstik • Press fittings

R0051

BSP hun - 60° konus
BSP female - 60° cone

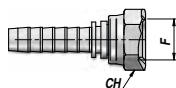

Codice Code Bestell-Nr.	Tubo Hose Schlauch		F BSP	CH	kg x 100
	inch	NW			
R0051.0302	3/16"	5	1/8"	14	1,60
R0051.0304	3/16"	5	1/4"	19	2,60
R0051.0404	1/4"	6	1/4"	19	2,80
R0051.0406	1/4"	6	3/8"	22	4,00
R0051.0506	5/16"	8	3/8"	22	4,20
R0051.0606	3/8"	10	3/8"	22	4,60
R0051.0608	3/8"	10	1/2"	27	7,00
R0051.0808	1/2"	13	1/2"	27	7,60
R0051.0810	1/2"	13	5/8"	28	8,60
R0051.0812	1/2"	13	3/4"	32	12,20
R0051.1010	5/8"	16	5/8"	28	8,60
R0051.1012	5/8"	16	3/4"	32	12,80
R0051.1212	3/4"	20	3/4"	32	12,40
R0051.1216	3/4"	20	1"	38	16,40
R0051.1616	1"	25	1"	38	21,40
R0051.2020	1"1/4	32	1"1/4	50	48,40
R0051.2424	1"1/2	40	1"1/2	55	60,00
R0051.3232	2"	50	2"	65	91,50

R0151

90° BSP hun - 60° konus
90° BSP female - 60° cone

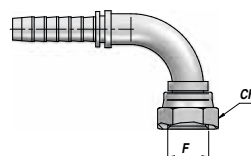

Codice Code Bestell-Nr.	Tubo Hose Schlauch		F BSP	CH	kg x 100
	inch	NW			
R0151.0302	3/16"	5	1/8"	14	2,00
R0151.0304	3/16"	5	1/4"	19	3,60
R0151.0404	1/4"	6	1/4"	19	3,80
R0151.0406	1/4"	6	3/8"	22	5,00
R0151.0506	5/16"	8	3/8"	22	5,60
R0151.0606	3/8"	10	3/8"	22	6,80
R0151.0608	3/8"	10	1/2"	27	8,60
R0151.0808	1/2"	13	1/2"	27	10,80
R0151.0810	1/2"	13	5/8"	28	14,20
R0151.1010	5/8"	16	5/8"	28	14,80
R0151.1012	5/8"	16	3/4"	32	17,00
R0151.1212	3/4"	20	3/4"	32	21,00
R0151.1216	3/4"	20	1"	38	25,40
R0151.1616	1"	25	1"	38	41,00
R0151.2020	1"1/4	32	1"1/4	50	78,00
R0151.2424	1"1/2	40	1"1/2	55	123,00
R0151.3232	2"	50	2"	65	165,20

R0251

45° BSP hun - 60° konus
45° BSP female - 60° cone

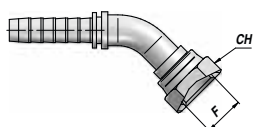

Codice Code Bestell-Nr.	Tubo Hose Schlauch		F BSP	CH	kg x 100
	inch	NW			
R0251.0404	1/4"	6	1/4"	19	3,60
R0251.0406	1/4"	6	3/8"	22	5,60
R0251.0506	5/16"	8	3/8"	22	6,20
R0251.0606	3/8"	10	3/8"	22	6,40
R0251.0608	3/8"	10	1/2"	27	9,40
R0251.0808	1/2"	13	1/2"	27	11,00
R0251.1010	5/8"	16	5/8"	28	14,80
R0251.1012	5/8"	16	3/4"	32	17,80
R0251.1212	3/4"	20	3/4"	32	18,60
R0251.1216	3/4"	20	1"	38	27,60
R0251.1616	1"	25	1"	38	34,80
R0251.2020	1"1/4	32	1"1/4	50	64,70
R0251.2424	1"1/2	40	1"1/2	55	94,50
R0251.3232	2"	50	2"	65	129,50

R2321

90° BSP kompakt hun - 60° konus
90° BSP compact female - 60° cone

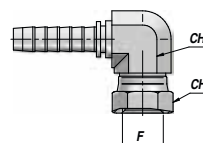

Codice Code Bestell-Nr.	Tubo Hose Schlauch		F BSP	CH	CH1	kg x 100
	inch	NW				
R2321.0404	1/4"	6	1/4"	19	14	6,40
R2321.0606	3/8"	10	3/8"	22	17	10,80
R2321.0808	1/2"	13	1/2"	27	24	16,80
R2321.1010	5/8"	16	5/8"	28	24	17,10
R2321.1212	3/4"	20	3/4"	32	27	26,40
R2321.1616	1"	25	1"	38	36	43,70

Indstik • Press fittings

R0350

BSP han - 60° konus
BSP male - 60° cone

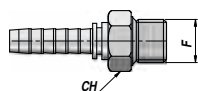

Codice Code Bestell-Nr.	Tubo Hose Schlauch		F BSP	CH	kg x 100
	inch	NW			
R0350.0402	1/4"	6	1/8"	15	1,40
R0350.0404	1/4"	6	1/4"	19	3,00
R0350.0406	1/4"	6	3/8"	22	4,20
R0350.0506	5/16"	8	3/8"	22	4,80
R0350.0606	3/8"	10	3/8"	22	5,00
R0350.0608	3/8"	10	1/2"	27	8,00
R0350.0808	1/2"	13	1/2"	27	9,20
R0350.1010	5/8"	16	5/8"	28	11,80
R0350.1012	5/8"	16	3/4"	32	13,40
R0350.1212	3/4"	20	3/4"	32	14,40
R0350.1616	1"	25	1"	38	26,40
R0350.2020	1"1/4	32	1"1/4	50	43,00
R0350.2424	1"1/2	40	1"1/2	55	52,20
R0350.3232	2"	50	2"	65	91,80

R0360

BSP konisk han
BSP tapered male

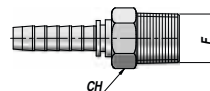

Codice Code Bestell-Nr.	Tubo Hose Schlauch		F BSP	CH	kg x 100
	inch	NW			
R0360.0404	1/4"	6	1/4"	14	2,90
R0360.0406	1/4"	6	3/8"	19	4,10
R0360.0506	5/16"	8	3/8"	19	4,70
R0360.0606	3/8"	10	3/8"	19	4,90
R0360.0608	3/8"	10	1/2"	22	7,80
R0360.0808	1/2"	13	1/2"	22	9,00
R0360.1212	3/4"	20	3/4"	27	14,00
R0360.1616	1"	25	1"	36	26,00
R0360.2020	1"1/4	32	1"1/4	46	42,50
R0360.2424	1"1/2	40	1"1/2	50	51,50
R0360.3232	2"	50	2"	65	90,20

R0370

NPTF han - 60° konus (SAEJ516)
NPTF male -60° cone(SAE J516)

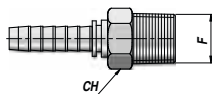

Codice Code Bestell-Nr.	Tubo Hose Schlauch		F NPTF	CH	kg x 100
	inch	NW			
R0370.0402	1/4"	6	1/8"	12	2,90
R0370.0404	1/4"	6	1/4"	14	4,10
R0370.0406	1/4"	6	3/8"	19	4,70
R0370.0606	3/8"	10	3/8"	19	4,90
R0370.0608	3/8"	10	1/2"	22	7,80
R0370.0808	1/2"	13	1/2"	22	9,00
R0370.1212	3/4"	20	3/4"	27	14,00
R0370.1616	1"	25	1"	36	26,00
R0370.2020	1.1/4"	32	1"1/4	46	42,50
R0370.2424	1.1/2"	40	1"1/2	50	51,50
R0370.3232	2"	50	2"	65	90,20

R1400

BSP banjo

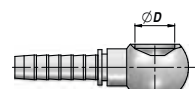

Codice Code Bestell-Nr.	Tubo Hose Schlauch		ØD	kg x 100
	inch	NW		
R1400.0304	3/16"	5	1/4"	3,20
R1400.0404	1/4"	6	1/4"	3,20
R1400.0406	1/4"	6	3/8"	4,60
R1400.0506	5/16"	8	3/8"	5,00
R1400.0606	3/8"	10	3/8"	4,60
R1400.0808	1/2"	13	1/2"	8,40
R1400.1212	3/4"	20	3/4"	17,40
R1400.1616	1"	25	1"	39,40