

HFR-SERIEN UDGÅR VED SALG.
ERSTATTES AF HFR25-SERIEN.

HFR cylinder

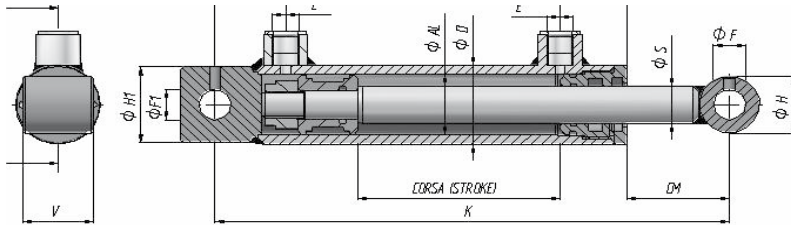

M250 dobbeltvirkende/double acting

Max. hastighed • Max. speed: 0,5 m/s
Arbejdstryk • Working pressure: 200 Bar
Spidstryk • Peak pressure: 250 Bar
Temperatur • Temperature: -25° til +80° C
Stempelstang • Piston rod: UNI C45 steel,
25 micron chrome (+/-5)
Rør • Tube: ST52.3, DIN2393, ISO H9

| Ø D | Ø AL | Ø S | Corsa Stroke Hub | Code Code Bestell-Nr. | K | CM | Kg. | | E | L | L1 | Ø H1 | Ø F1 | Ø H | V |
|-----|------------|-----|------------------|-----------------------|------|----|-------|------|----|----|----|------|------|-----|---|
| 35 | 25 | 16 | 50 | HFR0160050 | 160 | 31 | 1,00 | 1/4" | 23 | 22 | 35 | 12,1 | 25 | 25 | |
| | | | 100 | HFR0160100 | 210 | | 1,20 | | | | | | | | |
| | | | 150 | HFR0160150 | 260 | | 1,40 | | | | | | | | |
| | | | 200 | HFR0160200 | 310 | | 1,70 | | | | | | | | |
| 42 | 32 | 20 | 50 | HFR0200050 | 205 | 51 | 1,70 | 1/4" | 33 | 35 | 40 | 16,2 | 30 | 35 | |
| | | | 100 | HFR0200100 | 255 | | 2,10 | | | | | | | | |
| | | | 150 | HFR0200150 | 305 | | 2,40 | | | | | | | | |
| | | | 200 | HFR0200200 | 355 | | 2,80 | | | | | | | | |
| | | | 250 | HFR0200250 | 405 | | 3,10 | | | | | | | | |
| | | | 300 | HFR0200300 | 455 | | 3,50 | | | | | | | | |
| | | | 400 | HFR0200400 | 555 | | 4,20 | | | | | | | | |
| 500 | HFR0200500 | 655 | 4,80 | | | | | | | | | | | | |
| 50 | 40 | 25 | 100 | HFR1250100 | 270 | 42 | 3,23 | 3/8" | 40 | 45 | 50 | 20,5 | 40 | 40 | |
| | | | 150 | HFR1250150 | 320 | | 3,71 | | | | | | | | |
| | | | 200 | HFR1250200 | 370 | | 4,16 | | | | | | | | |
| | | | 250 | HFR1250250 | 420 | | 4,66 | | | | | | | | |
| | | | 300 | HFR1250300 | 470 | | 5,12 | | | | | | | | |
| | | | 400 | HFR1250400 | 570 | | 6,05 | | | | | | | | |
| | | | 500 | HFR1250500 | 670 | | 6,99 | | | | | | | | |
| | | | 600 | HFR1250600 | 770 | | 7,95 | | | | | | | | |
| | | | 800 | HFR1250800 | 970 | | 9,82 | | | | | | | | |
| 60 | 50 | 30 | 100 | HFR2300100 | 300 | 47 | 5,11 | 3/8" | 43 | 58 | 60 | 25,5 | 50 | 45 | |
| | | | 150 | HFR2300150 | 350 | | 5,74 | | | | | | | | |
| | | | 200 | HFR2300200 | 400 | | 6,33 | | | | | | | | |
| | | | 250 | HFR2300250 | 450 | | 6,97 | | | | | | | | |
| | | | 300 | HFR2300300 | 500 | | 7,60 | | | | | | | | |
| | | | 400 | HFR2300400 | 600 | | 8,83 | | | | | | | | |
| | | | 500 | HFR2300500 | 700 | | 10,05 | | | | | | | | |
| | | | 600 | HFR2300600 | 800 | | 11,27 | | | | | | | | |
| | | | 700 | HFR2300700 | 900 | | 12,40 | | | | | | | | |
| | | | 800 | HFR2300800 | 1000 | | 13,73 | | | | | | | | |
| | | | 900 | HFR2300900 | 1100 | | 14,97 | | | | | | | | |
| | | | 1000 | HFR2301000 | 1200 | | 16,08 | | | | | | | | |
| 70 | 60 | 30 | 100 | HFR3300100 | 300 | 48 | 6,30 | 3/8" | 50 | 58 | 70 | 25,5 | 50 | 45 | |
| | | | 150 | HFR3300150 | 350 | | 6,97 | | | | | | | | |
| | | | 200 | HFR3300200 | 400 | | 7,67 | | | | | | | | |
| | | | 250 | HFR3300250 | 450 | | 8,31 | | | | | | | | |
| | | | 300 | HFR3300300 | 500 | | 8,97 | | | | | | | | |
| | | | 350 | HFR3300350 | 550 | | 9,66 | | | | | | | | |
| | | | 400 | HFR3300400 | 600 | | 10,36 | | | | | | | | |
| | | | 450 | HFR3300450 | 650 | | 10,99 | | | | | | | | |
| | | | 500 | HFR3300500 | 700 | | 11,71 | | | | | | | | |
| 600 | HFR3300600 | 800 | 13,10 | | | | | | | | | | | | |
| 700 | HFR3300700 | 900 | 14,35 | | | | | | | | | | | | |

HFR-SERIEN UDGÅR VED SALG.
ERSTATTES AF HFR25-SERIEN.

HFR cylinder

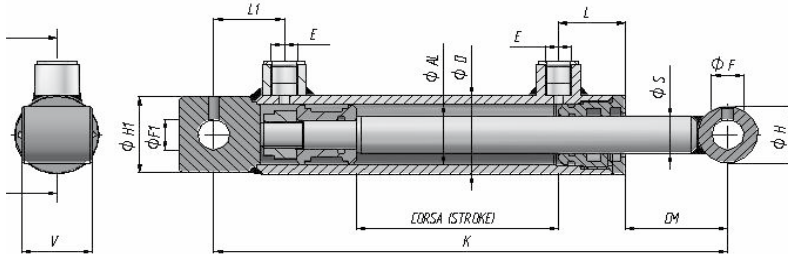

M250 dobbeltvirkende/double acting

Max. hastighed • Max. speed: 0,5 m/s
Arbejdsstryk • Working pressure: 200 Bar
Spidstryk • Peak pressure: 250 Bar
Temperatur • Temperature: -25° til +80° C
Stempelstang • Piston rod: UNI C45 steel, 25 micron chrome (+/-5)
Rør • Tube: ST52.3, DIN2393, ISO H9

| Ø D | Ø AL | Ø S | Corsa Stroke Hub | Codice Code Bestell-Nr. | K | CM | Kg. | | E | L | L1 | Ø H1 | Ø F1 | Ø H | V |
|-----|------|-----|------------------|-------------------------|------|-------|-------|------------|------|----|----|------|------|-----|----|
| 70 | 60 | 35 | 200 | HFR3350200 | 400 | 48 | 8,00 | | 3/8" | 50 | 58 | 70 | 25,5 | 50 | 45 |
| | | | 300 | HFR3350300 | 500 | | 9,55 | | | | | | | | |
| | | | 400 | HFR3350400 | 600 | | 11,10 | | | | | | | | |
| | | | 500 | HFR3350500 | 700 | | 12,65 | | | | | | | | |
| | | | 600 | HFR3350600 | 800 | | 14,20 | | | | | | | | |
| | | | 700 | HFR3350700 | 900 | | 15,75 | | | | | | | | |
| | | | 800 | HFR3350800 | 1000 | | 17,50 | | | | | | | | |
| | | | 900 | HFR3350900 | 1100 | | 19,00 | | | | | | | | |
| | | | 1000 | HFR3351000 | 1200 | 20,50 | | | | | | | | | |
| 80 | 70 | 40 | 200 | HFR4400200 | 410 | 48 | 10,45 | | 3/8" | 50 | 58 | 80 | 30,5 | 50 | 55 |
| | | | 250 | HFR4400250 | 460 | | 11,37 | | | | | | | | |
| | | | 300 | HFR4400300 | 510 | | 12,31 | | | | | | | | |
| | | | 350 | HFR4400350 | 560 | | 13,30 | | | | | | | | |
| | | | 400 | HFR4400400 | 610 | | 14,22 | | | | | | | | |
| | | | 450 | HFR4400450 | 660 | | 15,20 | | | | | | | | |
| | | | 500 | HFR4400500 | 710 | | 16,11 | | | | | | | | |
| | | | 600 | HFR4400600 | 810 | | 18,12 | | | | | | | | |
| | | | 700 | HFR4400700 | 910 | | 19,94 | | | | | | | | |
| | | | 800 | HFR4400800 | 1010 | | 21,50 | | | | | | | | |
| | | | 900 | HFR4400900 | 1110 | 23,50 | | | | | | | | | |
| 92 | 80 | 40 | 200 | HFR5400200 | 410 | 38 | 13,26 | | 3/8" | 60 | 58 | 90 | 30,5 | 50 | 55 |
| | | | 250 | HFR5400250 | 460 | | 14,46 | | | | | | | | |
| | | | 300 | HFR5400300 | 510 | | 15,54 | | | | | | | | |
| | | | 350 | HFR5400350 | 560 | | 16,72 | | | | | | | | |
| | | | 400 | HFR5400400 | 610 | | 18,00 | | | | | | | | |
| | | | 500 | HFR5400500 | 710 | | 20,00 | | | | | | | | |
| | | | 600 | HFR5400600 | 810 | | 22,00 | | | | | | | | |
| | | | 700 | HFR5400700 | 910 | | 24,50 | | | | | | | | |
| | | | 800 | HFR5400800 | 1010 | | 26,50 | | | | | | | | |
| | | | | | | | 900 | HFR5400900 | | | | | | | |
| | | | 1000 | HFR5401000 | 1210 | 31,00 | | | | | | | | | |
| 115 | 100 | 50 | 200 | HFR6500200 | 425 | 46 | 26,00 | | 3/8" | 82 | 50 | 115 | 30,5 | 65 | 70 |
| | | | 300 | HFR6500300 | 525 | | 30,00 | | | | | | | | |
| | | | 400 | HFR6500400 | 625 | | 34,00 | | | | | | | | |
| | | | 500 | HFR6500500 | 725 | | 38,00 | | | | | | | | |
| | | | 700 | HFR6500700 | 925 | | 41,10 | | | | | | | | |
| | | | 900 | HFR6500900 | 1125 | | 45,00 | | | | | | | | |
| | | | 1000 | HFR6501000 | 1225 | | 52,00 | | | | | | | | |

HFR2S cylinder

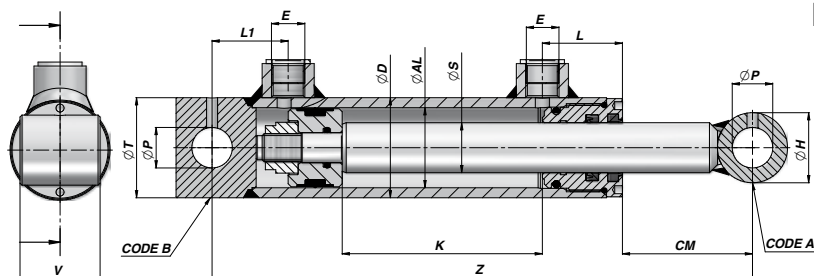

M250 dobbeltvirkende/double acting

Max. hastighed • Max. speed: 0,5 m/s
 Arbejdstryk • Working pressure: 200 Bar
 Spidstryk • Peak pressure: 250 Bar
 Temperatur • Temperature: -25° til +80° C
 Stempelstang • Piston rod: UNI C45 steel,
 SAE 1045, 25 micron chrome (+/-5)
 Rør • Tube: ST52.3, DIN2393, ISO H9

| Codice Code Bestell-Nr. | K | Z | kg | E BSP | L | L1 | CM | ØP | ØH | V | ØT | Code A | Code B | Codice Code Bestell-Nr. | K | Z | kg |
|---------------------------|------|------|-------|-------|----|----|----|-------|----|----|----|---------------|---------------|-------------------------|---|---|----|
| ØD 35 ØAL 25 ØS 16 | | | | | | | | | | | | | | | | | |
| HFR0160050 | 50 | 160 | 1,00 | | | | | | | | | | | | | | |
| HFR0160100 | 100 | 210 | 1,20 | | | | | | | | | | | | | | |
| HFR0160150 | 150 | 260 | 1,40 | 1/4" | 33 | 22 | 31 | 12,1 | 25 | 25 | 35 | | | | | | |
| HFR0160200 | 200 | 310 | 1,70 | | | | | | | | | CBF0012025025 | CFHR035025 | | | | |
| ØD 42 ØAL 32 ØS 20 | | | | | | | | | | | | | | | | | |
| HFR0200050 | 50 | 205 | 1,70 | | | | | | | | | | | | | | |
| HFR0200100 | 100 | 255 | 2,10 | | | | | | | | | | | | | | |
| HFR0200150 | 150 | 305 | 2,40 | | | | | | | | | | | | | | |
| HFR0200200 | 200 | 355 | 2,80 | 1/4" | 33 | 35 | 51 | 16,2 | 30 | 35 | 40 | | | | | | |
| HFR0200250 | 250 | 405 | 3,10 | | | | | | | | | | | | | | |
| HFR0200300 | 300 | 455 | 3,50 | | | | | | | | | | | | | | |
| HFR0200400 | 400 | 555 | 4,20 | | | | | | | | | | | | | | |
| HFR0200500 | 500 | 655 | 4,80 | | | | | | | | | CBF0016030035 | CFHR040032 | | | | |
| ØD 50 ØAL 40 ØS 25 | | | | | | | | | | | | | | | | | |
| HFR2S0400250100 | 100 | 270 | 3,00 | | | | | | | | | | | | | | |
| HFR2S0400250150 | 150 | 320 | 3,40 | | | | | | | | | | | | | | |
| HFR2S0400250200 | 200 | 370 | 3,90 | | | | | | | | | | | | | | |
| HFR2S0400250250 | 250 | 420 | 4,40 | | | | | | | | | | | | | | |
| HFR2S0400250300 | 300 | 470 | 4,80 | | | | | | | | | | | | | | |
| HFR2S0400250400 | 400 | 570 | 5,80 | 3/8" | 40 | 38 | 65 | 20,25 | 35 | 40 | 50 | | | | | | |
| HFR2S0400250500 | 500 | 670 | 6,70 | | | | | | | | | | | | | | |
| HFR2S0400250600 | 600 | 770 | 7,60 | | | | | | | | | | | | | | |
| HFR2S0400250700 | 700 | 870 | 8,60 | | | | | | | | | | | | | | |
| HFR2S0400250800 | 800 | 970 | 9,50 | | | | | | | | | CBF1020035040 | CFHR040020040 | | | | |
| ØD 60 ØAL 50 ØS 30 | | | | | | | | | | | | | | | | | |
| HFR2S0500300100 | 100 | 300 | 4,40 | | | | | | | | | | | | | | |
| HFR2S0500300150 | 150 | 350 | 5,00 | | | | | | | | | | | | | | |
| HFR2S0500300200 | 200 | 400 | 5,60 | | | | | | | | | | | | | | |
| HFR2S0500300250 | 250 | 450 | 6,20 | | | | | | | | | | | | | | |
| HFR2S0500300300 | 300 | 500 | 6,90 | | | | | | | | | | | | | | |
| HFR2S0500300400 | 400 | 600 | 8,10 | | | | | | | | | | | | | | |
| HFR2S0500300500 | 500 | 700 | 9,30 | | | | | | | | | | | | | | |
| HFR2S0500300600 | 600 | 800 | 10,50 | | | | | | | | | | | | | | |
| HFR2S0500300700 | 700 | 900 | 11,80 | | | | | | | | | | | | | | |
| HFR2S0500300800 | 800 | 1000 | 13,00 | | | | | | | | | | | | | | |
| HFR2S0500300900 | 900 | 1100 | 14,20 | | | | | | | | | | | | | | |
| HFR2S0500301000 | 1000 | 1200 | 15,50 | 3/8" | 43 | 42 | 85 | 25,25 | 40 | 45 | 60 | CBF1025040045 | CFHR050025049 | | | | |

HFR2S cylinder

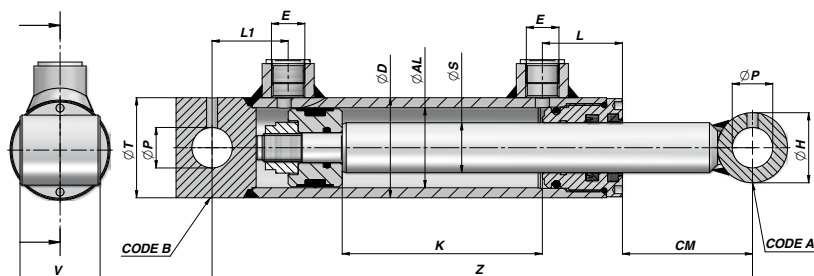

M250 dobbeltvirkende/double acting

Max. hastighed • Max. speed: 0,5 m/s
 Arbejdstryk • Working pressure: 200 Bar
 Spidstryk • Peak pressure: 250 Bar
 Temperatur • Temperature: -25° til +80° C
 Stempelstang • Piston rod: UNI C45 steel,
 SAE 1045, 25 micron chrome (+/-5)
 Rør • Tube: ST52.3, DIN2393, ISO H9

| Codice Code Bestell-Nr. | K | Z | kg | E BSP | L | L1 | CM | ØP | ØH | V | ØT | Code A | Code B | Codice Code Bestell-Nr. | K | Z | kg | | | |
|-----------------------------|------|------|-------|-------|----|----|----|-------|----|----|-----|---------------|----------------|-------------------------|------|------|---------------------------|--|--|--|
| ØD 70 ØAL 60 ØS 30 | | | | | | | | | | | | | | | | | ØD 70 ØAL 60 ØS 35 | | | |
| HFR2S0600300100 | 100 | 300 | 5,60 | | | | | | | | | | | | | | | | | |
| HFR2S0600300150 | 150 | 350 | 6,30 | | | | | | | | | | | | | | | | | |
| HFR2S0600300200 | 200 | 400 | 7,00 | | | | | | | | | | | HFR2S0600350200 | 200 | 400 | 7,50 | | | |
| HFR2S0600300250 | 250 | 450 | 7,70 | | | | | | | | | | | | | | | | | |
| HFR2S0600300300 | 300 | 500 | 8,30 | | | | | | | | | | | HFR2S0600350300 | 300 | 500 | 9,00 | | | |
| HFR2S0600300350 | 350 | 550 | 9,00 | | | | | | | | | | | | | | | | | |
| HFR2S0600300400 | 400 | 600 | 9,70 | | | | | | | | | | | HFR2S0600350400 | 400 | 600 | 10,60 | | | |
| HFR2S0600300450 | 450 | 650 | 10,40 | 3/8" | 50 | 36 | 83 | 25,25 | 40 | 45 | 70 | CBF1025040045 | CFHR060025047 | | | | | | | |
| HFR2S0600300500 | 500 | 700 | 11,00 | | | | | | | | | | | HFR2S0600350500 | 500 | 700 | 12,10 | | | |
| HFR2S0600300600 | 600 | 800 | 12,40 | | | | | | | | | | | HFR2S0600350600 | 600 | 800 | 13,70 | | | |
| HFR2S0600300700 | 700 | 900 | 13,70 | | | | | | | | | | | HFR2S0600350700 | 700 | 900 | 15,20 | | | |
| | | | | | | | | | | | | | | HFR2S0600350800 | 800 | 1000 | 16,80 | | | |
| | | | | | | | | | | | | | | HFR2S0600350900 | 900 | 1100 | 18,30 | | | |
| | | | | | | | | | | | | | | HFR2S0600351000 | 1000 | 1200 | 19,90 | | | |
| ØD 80 ØAL 70 ØS 40 | | | | | | | | | | | | | | | | | | | | |
| HFR2S0700400200 | 200 | 410 | 10,10 | | | | | | | | | | | | | | | | | |
| HFR2S0700400250 | 250 | 460 | 11,00 | | | | | | | | | | | | | | | | | |
| HFR2S0700400300 | 300 | 510 | 12,00 | | | | | | | | | | | | | | | | | |
| HFR2S0700400350 | 350 | 560 | 13,00 | | | | | | | | | | | | | | | | | |
| HFR2S0700400400 | 400 | 610 | 13,90 | | | | | | | | | | | | | | | | | |
| HFR2S0700400450 | 450 | 660 | 14,90 | 3/8" | 50 | 46 | 82 | 30,25 | 50 | 55 | 80 | CBF1030050055 | CFHR0700300063 | | | | | | | |
| HFR2S0700400500 | 500 | 710 | 15,80 | | | | | | | | | | | | | | | | | |
| HFR2S0700400600 | 600 | 810 | 17,70 | | | | | | | | | | | | | | | | | |
| HFR2S0700400700 | 700 | 910 | 19,60 | | | | | | | | | | | | | | | | | |
| HFR2S0700400800 | 800 | 1010 | 21,50 | | | | | | | | | | | | | | | | | |
| HFR2S0700400900 | 900 | 1110 | 23,40 | | | | | | | | | | | | | | | | | |
| ØD 92 ØAL 80 ØS 40 | | | | | | | | | | | | | | | | | | | | |
| HFR2S0800400200 | 200 | 410 | 13,00 | | | | | | | | | | | | | | | | | |
| HFR2S0800400250 | 250 | 460 | 14,20 | | | | | | | | | | | | | | | | | |
| HFR2S0800400300 | 300 | 510 | 15,30 | | | | | | | | | | | | | | | | | |
| HFR2S0800400350 | 350 | 560 | 16,40 | | | | | | | | | | | | | | | | | |
| HFR2S0800400400 | 400 | 610 | 17,50 | | | | | | | | | | | | | | | | | |
| HFR2S0800400500 | 500 | 710 | 19,80 | 3/8" | 60 | 42 | 70 | 30,25 | 50 | 55 | 90 | CBF1030050055 | CFHR0800300060 | | | | | | | |
| HFR2S0800400600 | 600 | 810 | 22,00 | | | | | | | | | | | | | | | | | |
| HFR2S0800400700 | 700 | 910 | 24,30 | | | | | | | | | | | | | | | | | |
| HFR2S0800400800 | 800 | 1010 | 26,50 | | | | | | | | | | | | | | | | | |
| HFR2S0800400900 | 900 | 1110 | 28,80 | | | | | | | | | | | | | | | | | |
| HFR2S0800401000 | 1000 | 1210 | 31,00 | | | | | | | | | | | | | | | | | |
| ØD 115 ØAL 100 ØS 50 | | | | | | | | | | | | | | | | | | | | |
| HFR2S1000500200 | 200 | 425 | 21,50 | | | | | | | | | | | | | | | | | |
| HFR2S1000500300 | 300 | 525 | 25,00 | | | | | | | | | | | | | | | | | |
| HFR2S1000500400 | 400 | 625 | 28,50 | | | | | | | | | | | | | | | | | |
| HFR2S1000500500 | 500 | 725 | 32,00 | 1/2" | 66 | 45 | 75 | 30,25 | 60 | 70 | 115 | CBF1030060070 | CFHR100300063 | | | | | | | |
| HFR2S1000500700 | 700 | 925 | 39,10 | | | | | | | | | | | | | | | | | |
| HFR2S1000500900 | 900 | 1125 | 46,10 | | | | | | | | | | | | | | | | | |
| HFR2S1000501000 | 1000 | 1225 | 49,60 | | | | | | | | | | | | | | | | | |