

## Indstik • Press fittings

### R1300

Lige SAE-flange 6000 PSI  
Straight SAE flange 6000 PSI

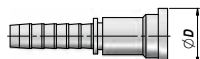

Codice Code Bestell-Nr.	Tubo Hose Schlauch		Ø Flangia Ø Flange Ø Flansch inch	ØD	kg x 100
	inch	NW			
R1300.0808	1/2"	13	1/2"	31,7	9,00
R1300.0812	1/2"	13	3/4"	41,3	16,00
R1300.1212	3/4"	20	3/4"	41,3	19,50
R1300.1216	3/4"	20	1"	47,6	28,00
R1300.1616	1"	25	1"	47,6	33,00
R1300.1620	1"	25	1"1/4	54	38,00
R1300.2020	1"1/4	32	1"1/4	54	54,00

### R1100

90° SAE-flange 6000 PSI  
90° SAE flange 6000 PSI

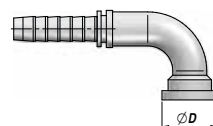

Codice Code Bestell-Nr.	Tubo Hose Schlauch		Ø Flangia Ø Flange Ø Flansch inch	ØD	kg x 100
	inch	NW			
R1100.0808	1/2"	13	1/2"	31,7	10,00
R1100.0812	1/2"	13	3/4"	41,3	15,00
R1100.1212	3/4"	20	3/4"	41,3	22,50
R1100.1216	3/4"	20	1"	47,6	34,00
R1100.1616	1"	25	1"	47,6	38,50
R1100.1620	1"	25	1"1/4	54	53,00
R1100.2020	1"1/4	32	1"1/4	54	60,00

### R1200

45° SAE-flange 6000 PSI  
45° SAE flange 6000 PSI

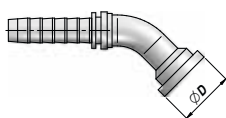

Codice Code Bestell-Nr.	Tubo Hose Schlauch		Ø Flangia Ø Flange Ø Flansch inch	ØD	kg x 100
	inch	NW			
R1200.0808	1/2"	13	1/2"	31,7	10,00
R1200.0812	1/2"	13	3/4"	41,3	17,50
R1200.1212	3/4"	20	3/4"	41,3	20,50
R1200.1216	3/4"	20	1"	47,6	30,50
R1200.1616	1"	25	1"	47,6	38,50
R1200.1620	1"	25	1"1/4	54	45,50
R1200.2020	1"1/4	32	1"1/4	54	54,50

### R5006

SAE-flangesæt 6000 PSI  
SAE split flange 6000 PSI

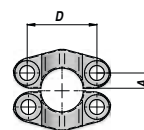

Codice Code Bestell-Nr.	Per Flangia For Flange Für Flansch inch	D	A	kg x 100
R5006.1200	3/4"	50,8	11,9	30,50
R5006.1600	1"	57,1	13,9	50,50
R5006.2000	1"1/4	66,7	15,8	79,50
R5006.2400	1"1/2	79,4	18,2	135,00
R5006.3200	2"	96,8	22,2	216,50